

# Defender Series Pro Installation Instructions

**1** Remove case from holster (if applicable).

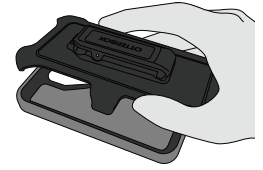

**2** Peel away and remove the outer slipcover.

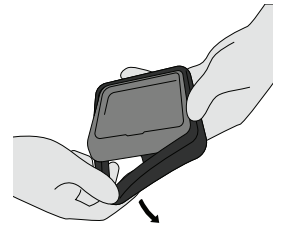

**3** The shell separates into two pieces. To separate, find the arrows\* on the shell back and release the corresponding snaps on the shell's side.

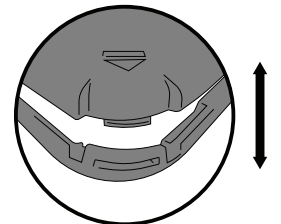
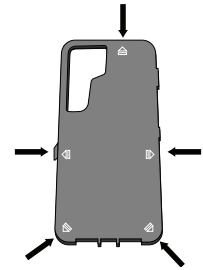

\*Arrow locations may vary by device

**4** Place the device into the bottom half of the shell.

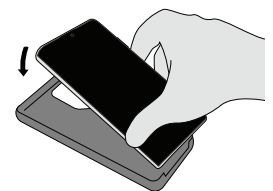

**5** Place the shell top half on the device and snap the two pieces together along all edges.

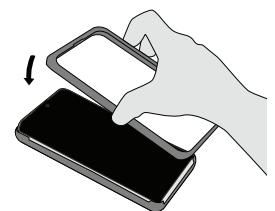

**6**

Wrap the slipcover around the shell. Ensure silicone slipcover is nested in groove and notches on all sides for a tight, secure fit.

